

Jet Blaster blows powerful compressed air on the adhered powder, It is a device to prevent powder adhesion and clogging.

Feature of Jet Blaster

Feature of Jet Blaster

- 1 Because the tank is made of stainless steel, it is superlightweight.
- 2 Low noise (65 dB at air discharge)
- 3 Air discharge direction can be changed by changing nozzle
- 4 Explosion proof specifications are also possible
- 5 N₂ gas can also be used as discharge fluid
- 6 Simple structure and capable of facilitating maintenance and replacement of parts
- 7 Abundant model
- 8 Can be installed in high temperature places
- 9 The power of discharge air can be converted by converting air pressure

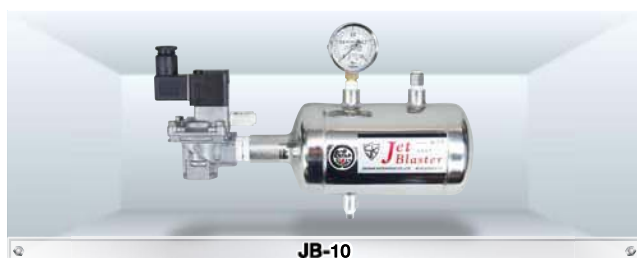

JB-10



JB-30



JB-100



JB-300

Model	JB-10	JB-30	JB-100	JB-300
Tank capacity (L)	1	3	10	30
Pressure (MPa)	0.1~0.7	0.1~0.7	0.1~0.7	0.1~0.7
Total weight (kg)	5.4	7.5	20.1	35.4
Powder contact area material	SUS304	SUS304	SUS304	SUS304

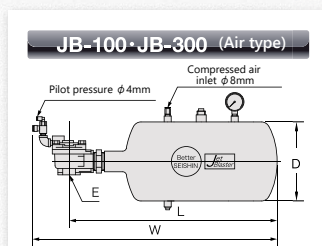
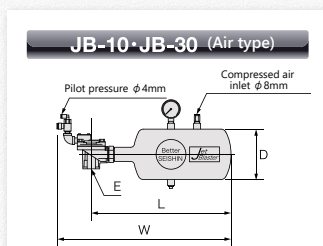
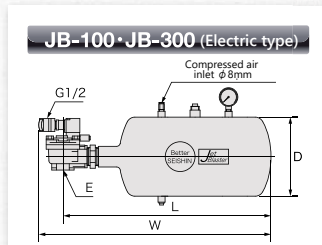
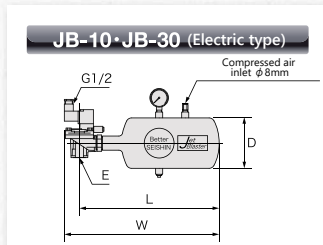

Dimension	L	W	D	E
JB-10 (Electric type)	(297)	(343)	φ100	20A
JB-10 (Air type)	(297)	(381)	φ100	20A
JB-30 (Electric type)	(375)	(416)	φ135	25A
JB-30 (Air type)	(375)	(468)	φ135	25A
JB-100 (Electric type)	(558)	(624)	φ212	40A
JB-100 (Air type)	(558)	(657)	φ212	40A
JB-300 (Electric type)	(826.3)	(901.3)	φ265.4	50A
JB-300 (Air type)	(826.3)	(901.3)	φ265.4	50A

(mm)

About the model choice of Jet blaster

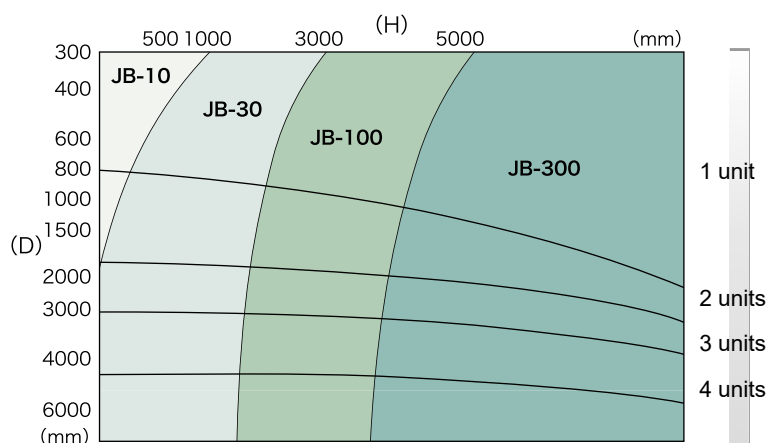
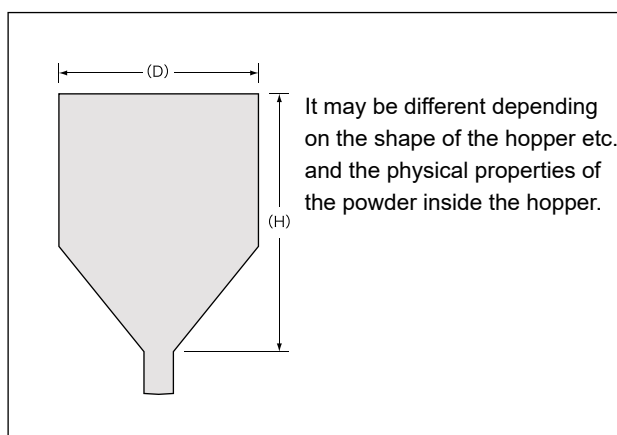

Control box for Jet blaster

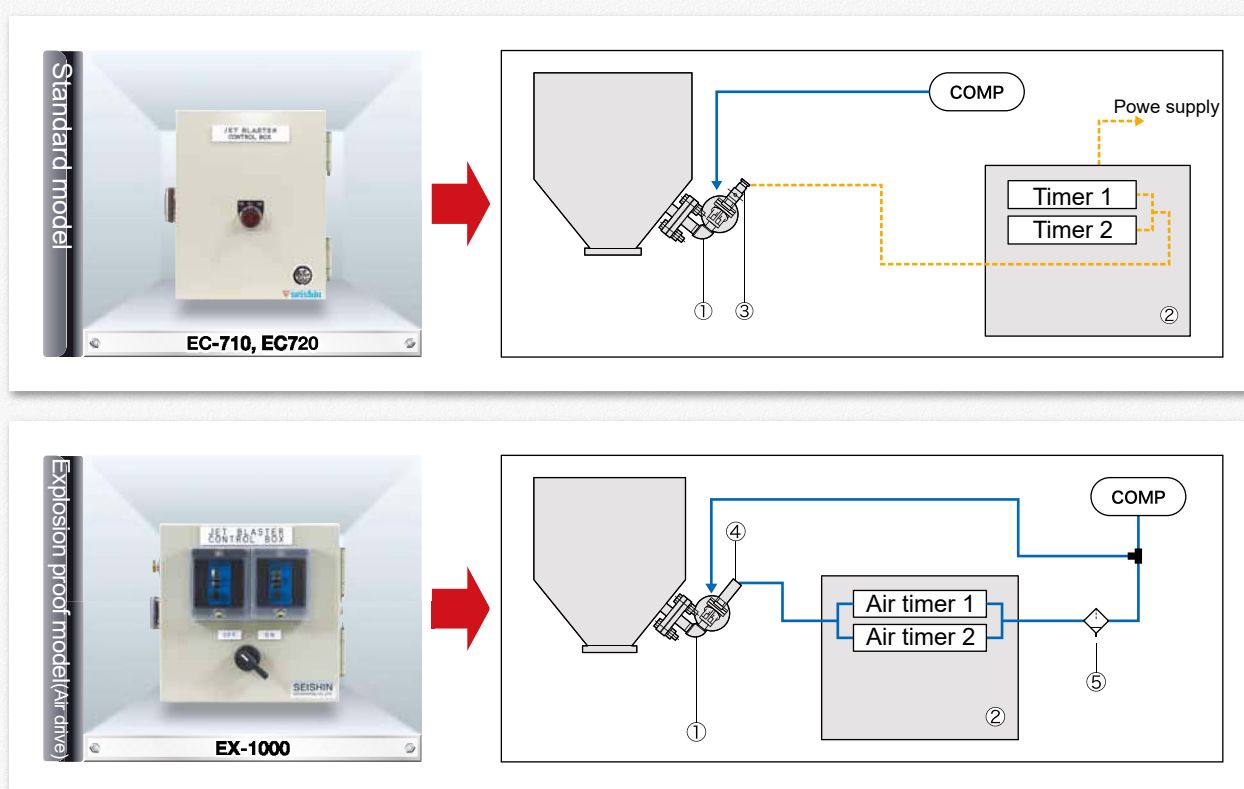

Model	EC-710	EC-720	EX-1000
Specifacaton	Electric non-explosion-proof		Air type explosion-proof
Paint color	Munsell 5Y7/1		Munsell 5Y7/1
Dimension	200W×120D×250H		200W×120D×200H
Weight	Approximately 3.9 kg		Approximately 3.4 kg
Power supply	1Ph, AC100V(EC-700) / 1Ph, AC200V(EC-720)		Air control
Timer specification	Air discharge time : 0.2 ~ 2sec Air discharge interval : 0.5sec ~ 30h 4 range switching		Air discharge time : 0.2 ~ 2sec Air discharge interval : 20sec ~ 250sec
Required air pressure	-		0.3MPa~0.6MPa
Capacity	Simultaneous control: 4 units		Simultaneous control: 4 units

Custom-made control boxes according to customer's specifications can also be produced.

Jet blaster operation principle

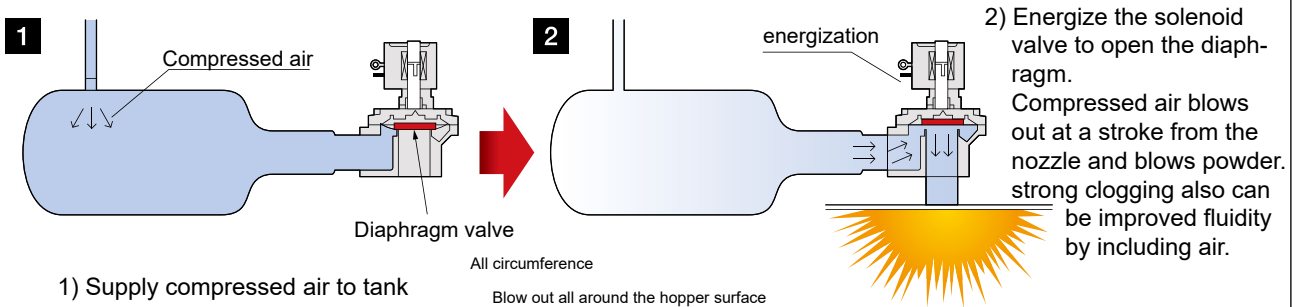

1. Difference in ejection direction depending on nozzle type

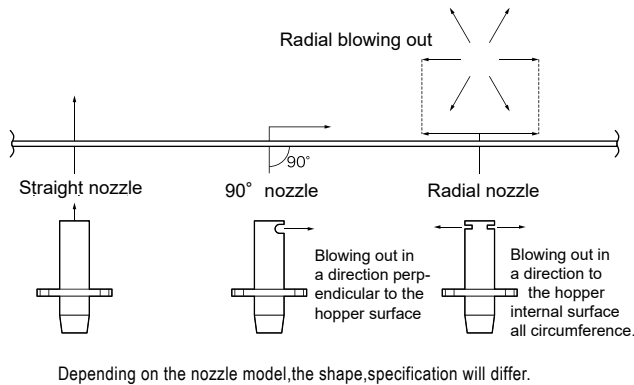

2. Direction of air blowing out depending on powder state

Reference example

- In case of adhesion, using a radial nozzle.
- In case of bridge or rat hole, using 90° nozzle.

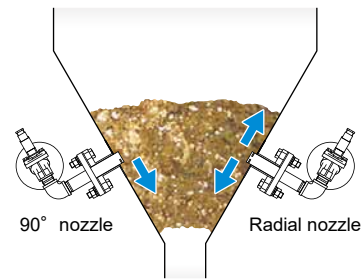

Mounting method of Jet blaster

Base plate mounting direction

Good ○

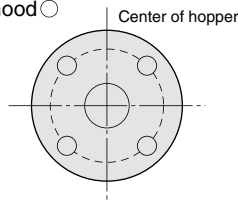

Base plate mounting direction

NG ×

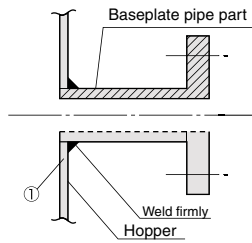
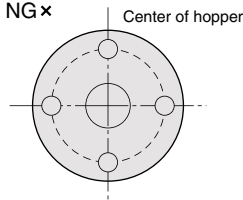

Model	Baseplate pipe standard	Mounting hole size
JB-10	JIS SUS 25A	φ 34.0
JB-30	JIS SUS 32A	φ 42.7
JB-100	JIS SUS 50A	φ 60.5
JB-300	JIS SUS 65A	φ 76.3

Installation reference drawing

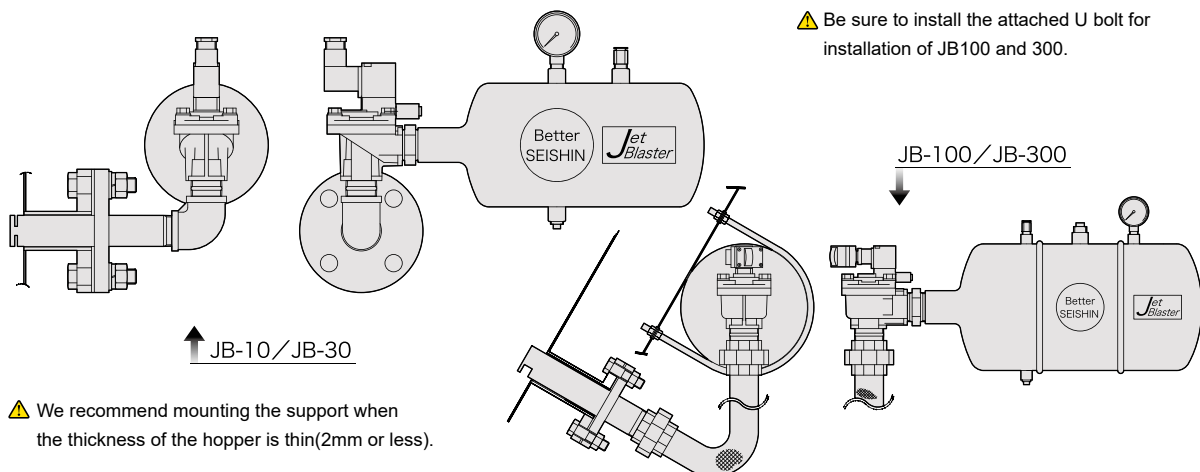

Piston Vibrator



NTK series

It's a unique air cushion type in which the tip of the piston protrudes outside the casing, and it is best for hopper, feeder, chute, etc.

Specification of Ntter piston vibrator

Model	Drive part		Working moment(cmkkg)		Frequency(min-1)		Vibration force(N)		Air consumption(L/min)		Noize level(dB(A))	
	Driver	Vibration load(kg)	0.2MPa	0.6MPa	0.2MPa	0.6MPa	0.2MPa	0.6MPa	0.2MPa	0.6MPa	0.2MPa	0.6MPa
NTK8AL	Piston	0.030	0.05	0.06	2,440	3,657	15	44	7	32	61	75
NTK15x	Piston	0.135	0.29	0.29	1,745	2,544	49	104	17	72	53	64
NTK16	Piston	0.150	0.27	0.34	1,680	2,400	42	106	14	58	54	67
NTK18AL	Piston	0.210	0.29	0.36	1,600	2,350	41	109	19	68	55	68
NTK25AL	Piston	0.420	1.18	1.24	1,289	1,986	107	269	34	149	56	73
NTK25	Piston	0.470	1.12	1.32	1,40	2,270	127	374	38	156	57	73
NTK40AL	Piston	1.240	2.88	2.16	1,231	2,094	239	519	54	220	58	70
NTK40	Piston	1.270	3.57	2.46	1,200	1,930	282	503	49	228	58	70
NTK55AL	Piston	2.100	3.62	2.66	1,500	2,400	447	839	98	398	62	71

Vacuum Clamp

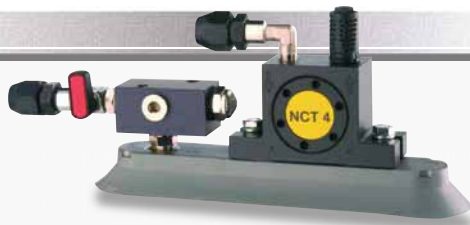

VAC series

Ideal for hoppers and containers where welding, electricity can not be used.
Urgent, ideal for carrying, easy to detach.

Lineup and Dimension

Model	A[mm]	B[mm]	C[mm]	D[mm]	E[mm]	F[mm]	G[mm]
VAC 8	20	30	150	53	33	55	190
VAC 10	22	40	200	53	31	55	245
VAC 11	19	40	300	53	31	55	330
VAC 12	25	60	300	60	72	100	330

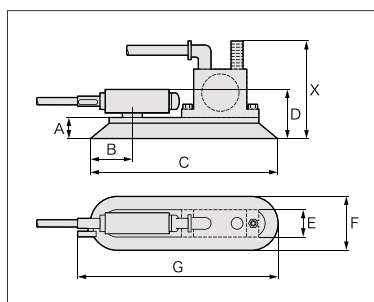

Rich variation



- Quick attachment without bolting or welding
- Strong connection due to high-pressure vacuum
- Can be used on curved or uneven surfaces
- Optional air economizer
- ATEX-compliant and stainless steel versions available
- Customized versions possible

Prevent powder clogging and remove fine iron powder. Devices for removing fine iron and stainless chips.



Excellent features of Rotary catcher

- 1 Ideal for removing metallic foreign matter in powder.
- 2 Can be installed in the line. By installing a rotary catcher in the final process, high iron removal effect can be obtained.
- 3 Fine iron powder of 1 mm or less which can not be detected with a metal detector, can be collected with a high-powered magnet of 13000 gauss or more which has been upgraded.
- 4 Easy to disassemble, cleaning and assembly. Efficient removal of iron powder. Even stainless chips can be collected. (However, it depends on particle size, shape, etc.)

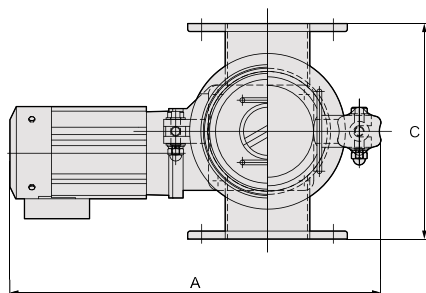
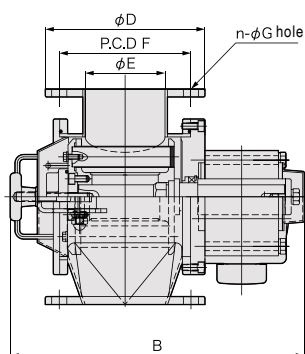

Model	MRC-100A	MRC-150A	MRC-200A	MRC-250A
Flange diameter	100A	150A	200A	250A
Number of magnets	4	6	6	8
Material of powder contact surface	SUS304	SUS304	SUS304	SUS304
Rotation speed (min-1)(50/60Hz)	25/30	25/30	25/30	25/30
Motor (kw)	0.25	0.4	0.4	0.4

※ Magnetic force : Residual magnetic flux density 1.3 T(13000G) is the standard specification.
Can be changed to 1.5T specification

※ Flange equivalent to JIS 5K FF

Model	MRC-100A	MRC-150A	MRC-200A	MRC-250A
A	453	478	508	538
B	368	442	484	585
C	270	330	380	440
ϕD	200	265	320	385
ϕE	100	150	200	250
P.C.D F	165	230	280	345
n	8	8	8	12
ϕG	19	19	23	23

(mm)

Disassembly ▫ Cleaning ▫ Assembly



Housing type magnet

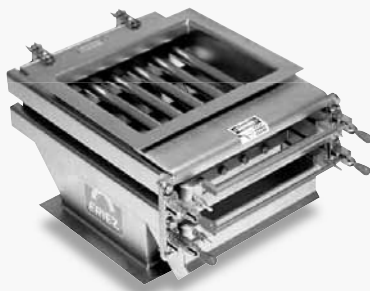

This product can be used in all industries such as plastics, foods, flour, sugar, grain, paint, chemical, carbon black and minerals.

TG type (Magnet spacing:25mm)

Remove micro iron pieces such as pins and clips to prevent wear and breakage of machinery and equipment

FG type (Magnet spacing:13mm)

Remove fine iron powder to improve quality

TGH Housing type 2step model Tramp Iron Grate In Housing

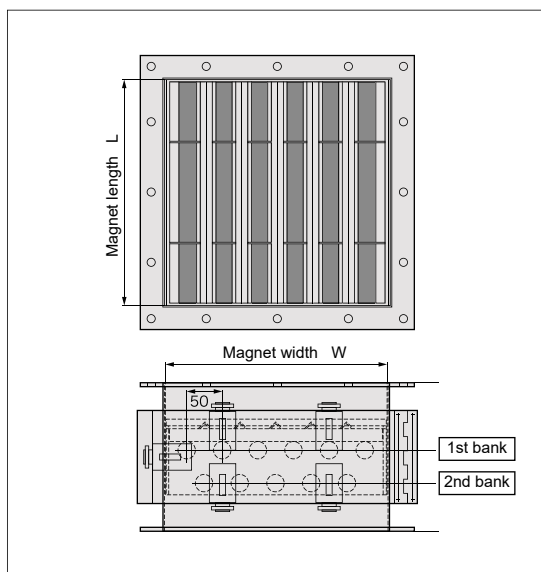

TGH-2

W × L (mm)	Number of magnets
	1st bank / 2nd bank
220 × 150	4 / 3
270 × 200	5 / 4
320 × 250	6 / 5
370 × 300	7 / 6
420 × 360	8 / 7
470 × 410	9 / 8
570 × 510	11 / 10
620 × 560	12 / 11
670 × 610	13 / 12
720 × 660	14 / 13

※ Please contact us for special size.

FGH Housing type 4step model Fine Iron Grate In Housing

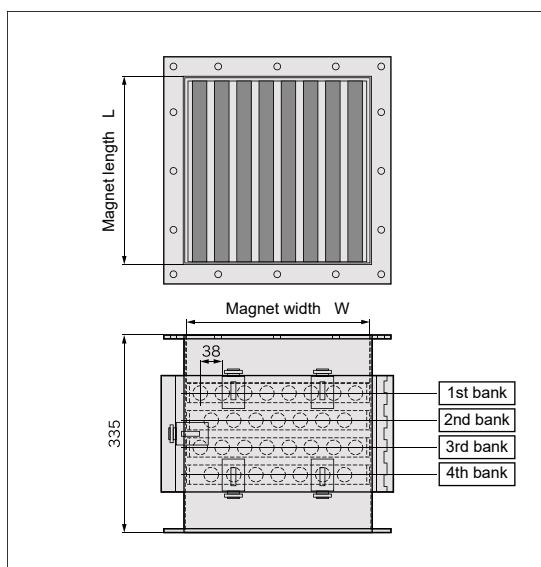

FGH-2

W × L (mm)	Number of magnets
	1st bank · 2nd bank / 3rd bank · 4th bank
220 × 150	4 / 3
270 × 200	5 / 4
320 × 250	6 / 5
370 × 300	7 / 6
420 × 360	8 / 7
470 × 410	9 / 8
570 × 510	11 / 10
620 × 560	12 / 11
670 × 610	13 / 12
720 × 660	14 / 13

※ Please contact us for special size.

※ Multi-stage type other than 4-stage type can also be manufactured.

FLEXICEPLA

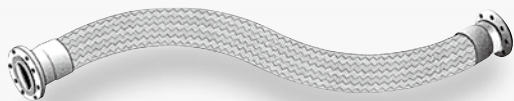

FLEXICEPLA (Inner surface alumina sleeve, outer pipe SUS blade) is a wear-resistant hose that can bend freely.

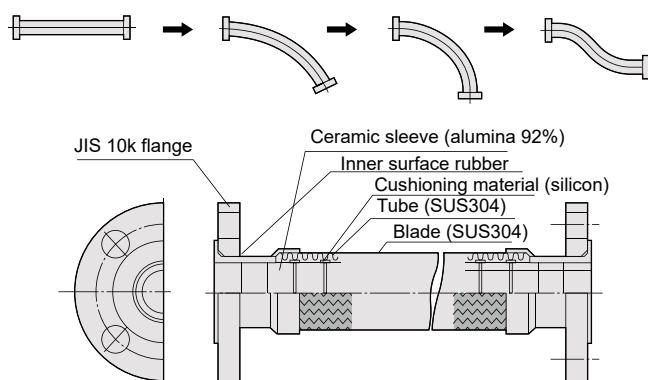

Terms of use

- Operating temperature / -20°C ~ 80°C
- Available bendable Please do not use it bent below R
- Please use at maximum operating pressure 1 MPa or less

	Inner diameter	Joint	Usable range			
			1000L		1500L	
20A	φ19 (S-20)	20A 10kg loose flange	≒R600	90°	≒R600	90°
25A	φ25 (S-25)	25A 10kg loose flange	≒R600	90°	≒R600	90°
	φ28 (S-25)	25A 10kg loose flange	≒R600	90°	≒R600	90°
32A	φ32 (S-32)	32A 10kg loose flange	≒R600	90°	≒R600	90°
	φ36 (S-32)	32A 10kg loose flange	≒R600	90°	≒R600	90°
40A	φ39 (S-40)	40A 10kg loose flange	≒R600	90°	≒R600	90°
	φ43 (S-40)	40A 10kg loose flange	≒R600	90°	≒R600	90°
50A	φ51 (S-50)	50A 10kg loose flange	≒R800	75°	≒R800	90°
	φ54 (S-50)	50A 10kg loose flange	≒R800	75°	≒R800	90°
65A	φ63 (S-65)	65A 10kg loose flange	≒R800	45°	≒R800	90°
	φ69 (S-65)	65A 10kg loose flange	≒R800	45°	≒R800	90°
80A	φ73 (S-80)	80A 10kg loose flange	≒R1200	45°	≒R1200	90°
	φ81 (S-80)	80A 10kg loose flange	≒R1200	45°	≒R1200	90°
100A	φ97 (S-100)	100A 10kg loose flange	≒R1200	30°	≒R1200	30°
					≒R1200	75°

Place of use

When piping works on site

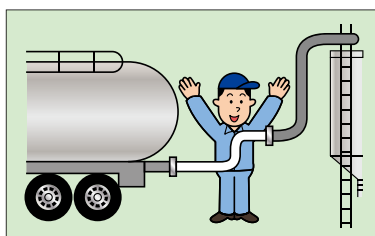
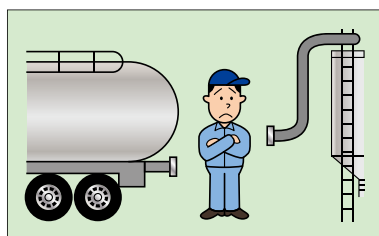

Intense place of the vibration

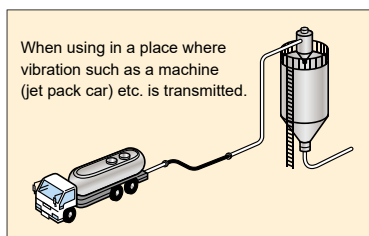

In addition, various piping, cyclone, ejector etc. can also be ceramized so please inquire.

The following piping can also be ceramized.

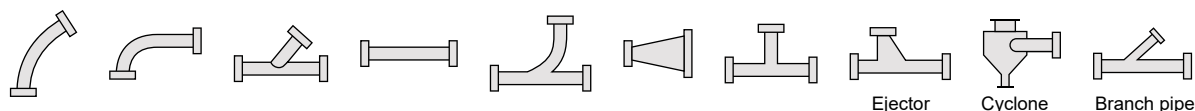

Installation Record

Troubleshooting equipment handled by Seishin Enterprise Co., Ltd. is active in various fields. We will respond to customer's needs, utilize our abundant knowledge and experience, and will support you with full power.
Please contact us if you need help with powder and granular equipments



Pulverising / classification equipments



Supply and transport equipment



Storage facility



Foreign matter removal equipment



Storage and transportation equipment



Supply equipment

Recommended for adhesion measures at hopper, silo designning

We accept data measurement necessary for hopper design with Jenike & Johanson shear testing machine.

By performing a shear test, it is possible to experimentally obtain the frictional force and adhesion of the powder.
You can presume the tilt angle, exit diameter, etc. required for hopper and silo design using that numerical value.

▼ Measurement item of shear test

Internal friction angle test

Wall friction angle test

Stillness storage period test



Dust explosion test

It is a test to judge explosive properties of powder. The powder is scattered by compressed air inside the container, and the explosiveness is judged by ignition by the electric fireworks.

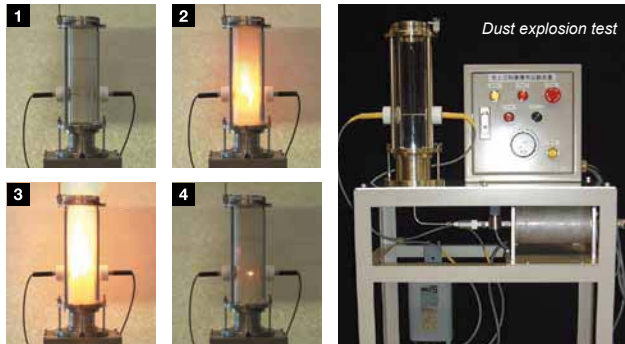

▼ Measurement item of dust explosion test

Explosion lower limit concentration

Maximum safe percentage of oxygen

Minimum ignition energy

Maximum Explosive Pressure

Explosion pressure increase speed

kst value

※This equipment is for normal powders, but not for dangerous substance (toxic material, explosive substance). In the case of using for dangerous substance, please install the necessary measures.

※In the case of using the equipment in overseas, it is necessary to offer export country name, company name and end use etc in advance. Please feel free to contact the person in charge. Your kind understanding would be much appreciated.

※The specification of goods and the pictures in this catalog will be changed without notice.



SEISHIN
ENTERPRISE CO., LTD.

SEISHIN ENTERPRISE CO., LTD.

HomePage : <http://www.betterseishin.co.jp> E-mail : info@betterseishin.co.jp

■ **Head Office** NEX Shinjuku BLDG, 5-34,7, Sendagaya, Shibuya-ku, Tokyo, 151-0051, JAPAN
TEL +81-3-3350-5771 FAX +81-3-3350-5860

■ **Overseas department** e mail overseas@betterseishin.co.jp
TEL +81-3-3350-5771 FAX +81-3-3350-5860

■ **Koga delivery center** 740, Koga, Koga, Ibaragi, 306-0016, JAPAN
TEL +81-280-32-3111 FAX +81-280-32-3112

inquiry